

# Pneumatic actuator (A/R series)

## 内容

A series 拨叉式  
零件清单

A series 拨叉式  
选型指南  
尺寸表

A series 拨叉式  
扭矩表

R series 齿轮齿条  
零件清单

R series 齿轮齿条  
选型指南  
尺寸表

R series 齿轮齿条  
扭矩表

多种选择

限位开关

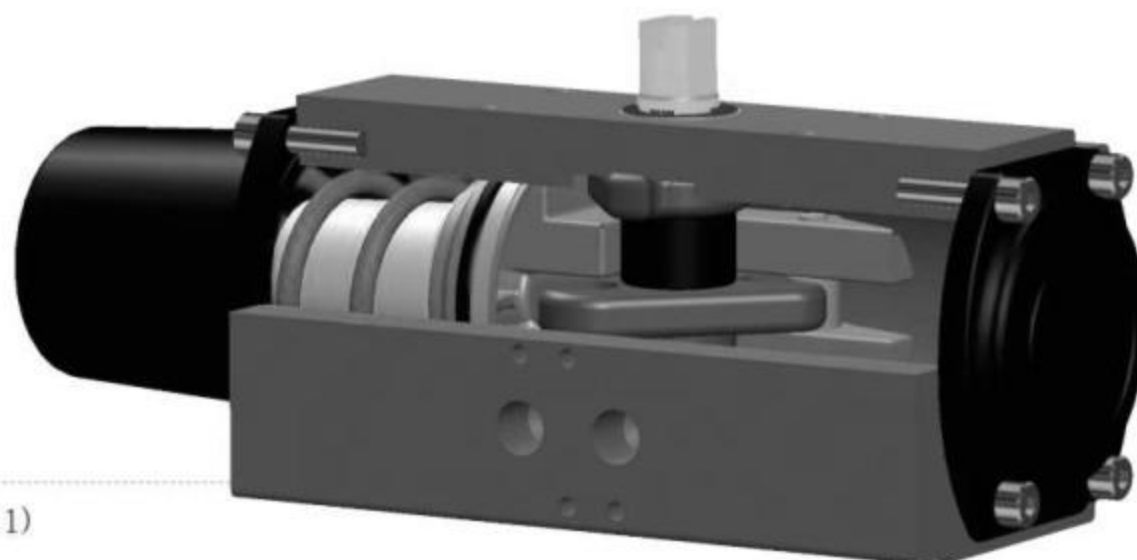

- 国际标准 (DIN3337、NAMUR、ISO5211)
- 硬质阳极氧化铝主体和粉末涂层端盖

- 工作介质为压缩空气，滤除异物或灰尘，其尺寸最大不应超过40 $\mu$  (ISO 8573第1部分，5级)。
- 供给介质必须采用除湿气动压力，如果空气中有水分，必须安装单独的除湿装置。

• 工作气压：3~8Bar

• 推荐压力：4~6Bar

• 设计压力：10Bar

## 型号范围



### A D 65

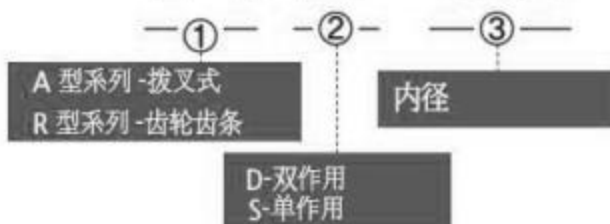

AD	50/65/80/100/125/140/160/185/210/250/300
AS	50/65/80/100/125/140/160/185/210/250/300
RD	32/40/50/65/80/90/100/115/125/140/160/185/210
RS	40/50/65/80/90/100/115/125/140/160/185/210

## 型号代码

# A6ND-AKKB-1012C27-OP

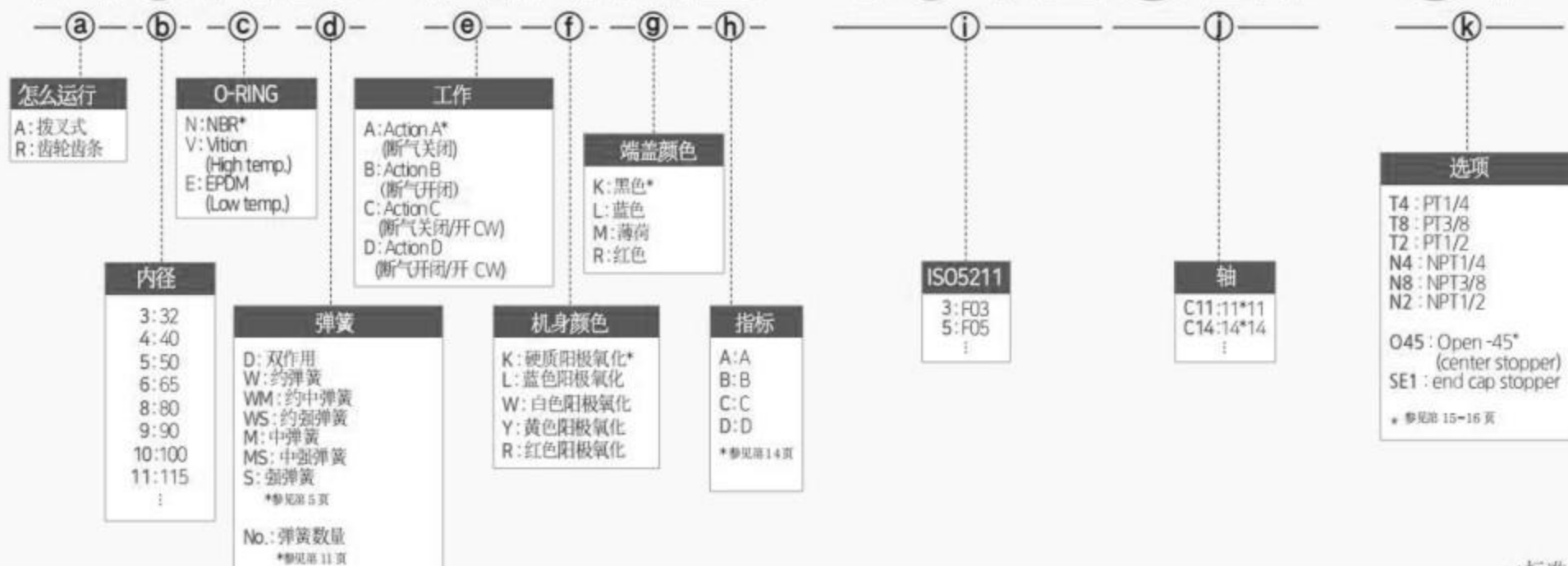

\*标准

- 为了提高产品的性能和安全性，目录中包含的数据a可能会发生更改，恕不另行通知。
- 联系我们获取最新的产品和技术信息。请访问我们的网站了解更多详情：<http://www.yeah-valve.com>

# 零件

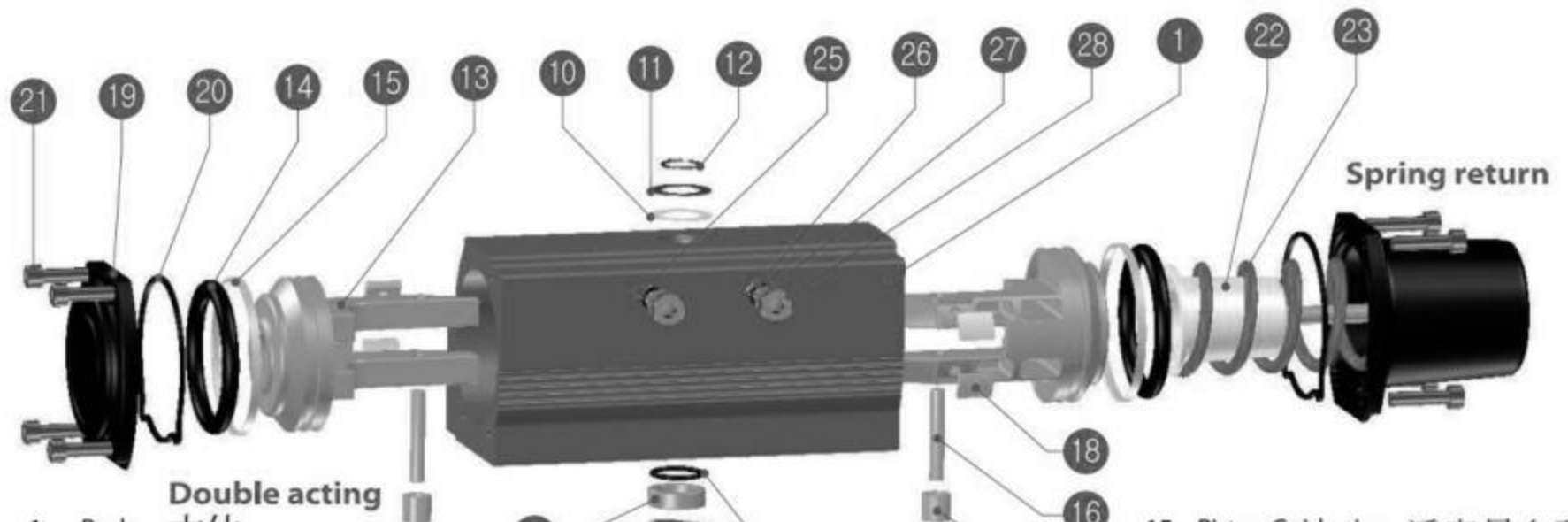

- Double acting**
- |                                  |                                  |                                  |                                 |                             |                       |                        |                         |
|----------------------------------|----------------------------------|----------------------------------|---------------------------------|-----------------------------|-----------------------|------------------------|-------------------------|
| 1. Body 本体                       | 4. Bushing (Top) 衬套 (顶部)         | 7. Bushing (Bottom) 本体环 (下)      | 10. Body Washer (Bottom) 扁环 (下) | 13. Piston 活塞               | 16. Piston Pin 活塞销    | 19. End Cap 盖          | 22. Spring Cap 弹簧帽      |
| 2. Shaft 轴                       | 5. Body O-ring (Top) 本体密封 (上)    | 8. Body O-ring (Bottom) 本体密封 (下) | 11. Body Washer (Top) 扁环 (上)    | 14. Piston O-ring 活塞密封      | 17. Piston Roller 活塞辊 | 20. End Cap O-ring 盖密封 | 23. Spring 弹簧           |
| 3. Crank 曲柄                      | 6. Shaft Roller (Top) 轴辊 (上)     | 9. Shaft Roller (Bottom) 轴辊 (下)  | 12. Body Snap-ring 止动环          | 15. Piston Guide-ring 活塞导向环 | 18. Piston Pad 活塞垫    | 21. End Cap Screw 盖螺栓  | 24. Stopper 停顿          |
| 4. Bushing (Top) 衬套 (顶部)         | 24. Stopper 停顿                   |                                  |                                 |                             |                       |                        | 25. Stopper Screw 停顿螺栓  |
| 5. Body O-ring (Top) 本体密封 (上)    | 6. Shaft Roller (Top) 轴辊 (上)     |                                  |                                 |                             |                       |                        | 26. Stopper O-ring 停顿密封 |
| 6. Shaft Roller (Top) 轴辊 (上)     | 7. Bushing (Bottom) 本体环 (下)      |                                  |                                 |                             |                       |                        | 27. Stopper Washer 停顿扁环 |
| 7. Bushing (Bottom) 本体环 (下)      | 8. Body O-ring (Bottom) 本体密封 (下) |                                  |                                 |                             |                       |                        | 28. Stopper Nut 停顿螺母    |
| 8. Body O-ring (Bottom) 本体密封 (下) | 9. Shaft Roller (Bottom) 轴辊 (下)  |                                  |                                 |                             |                       |                        |                         |
| 9. Shaft Roller (Bottom) 轴辊 (下)  | 10. Body Washer (Bottom) 扁环 (下)  |                                  |                                 |                             |                       |                        |                         |
| 10. Body Washer (Bottom) 扁环 (下)  | 11. Body Washer (Top) 扁环 (上)     |                                  |                                 |                             |                       |                        |                         |
| 11. Body Washer (Top) 扁环 (上)     | 12. Body Snap-ring 止动环           |                                  |                                 |                             |                       |                        |                         |
| 12. Body Snap-ring 止动环           | 13. Piston 活塞                    |                                  |                                 |                             |                       |                        |                         |
| 13. Piston 活塞                    | 14. Piston O-ring 活塞密封           |                                  |                                 |                             |                       |                        |                         |
| 14. Piston O-ring 活塞密封           | 15. Piston Guide-ring 活塞导向环      |                                  |                                 |                             |                       |                        |                         |
| 15. Piston Guide-ring 活塞导向环      | 16. Piston Pin 活塞销               |                                  |                                 |                             |                       |                        |                         |
| 16. Piston Pin 活塞销               | 17. Piston Roller 活塞辊            |                                  |                                 |                             |                       |                        |                         |
| 17. Piston Roller 活塞辊            | 18. Piston Pad 活塞垫               |                                  |                                 |                             |                       |                        |                         |
| 18. Piston Pad 活塞垫               | 19. End Cap 盖                    |                                  |                                 |                             |                       |                        |                         |
| 19. End Cap 盖                    | 20. End Cap O-ring 盖密封           |                                  |                                 |                             |                       |                        |                         |
| 20. End Cap O-ring 盖密封           | 21. End Cap Screw 盖螺栓            |                                  |                                 |                             |                       |                        |                         |
| 21. End Cap Screw 盖螺栓            | 22. Spring Cap 弹簧帽               |                                  |                                 |                             |                       |                        |                         |
| 22. Spring Cap 弹簧帽               | 23. Spring 弹簧                    |                                  |                                 |                             |                       |                        |                         |
| 23. Spring 弹簧                    | 24. Stopper 停顿                   |                                  |                                 |                             |                       |                        |                         |
| 24. Stopper 停顿                   | 25. Stopper Screw 停顿螺栓           |                                  |                                 |                             |                       |                        |                         |
| 25. Stopper Screw 停顿螺栓           | 26. Stopper O-ring 停顿密封          |                                  |                                 |                             |                       |                        |                         |
| 26. Stopper O-ring 停顿密封          | 27. Stopper Washer 停顿扁环          |                                  |                                 |                             |                       |                        |                         |
| 27. Stopper Washer 停顿扁环          | 28. Stopper Nut 停顿螺母             |                                  |                                 |                             |                       |                        |                         |
| 28. Stopper Nut 停顿螺母             |                                  |                                  |                                 |                             |                       |                        |                         |

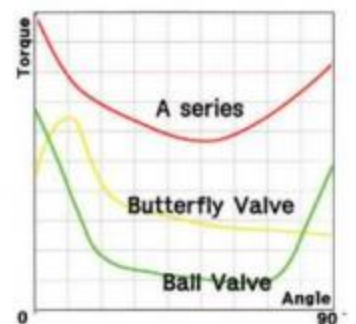

# 运行机制

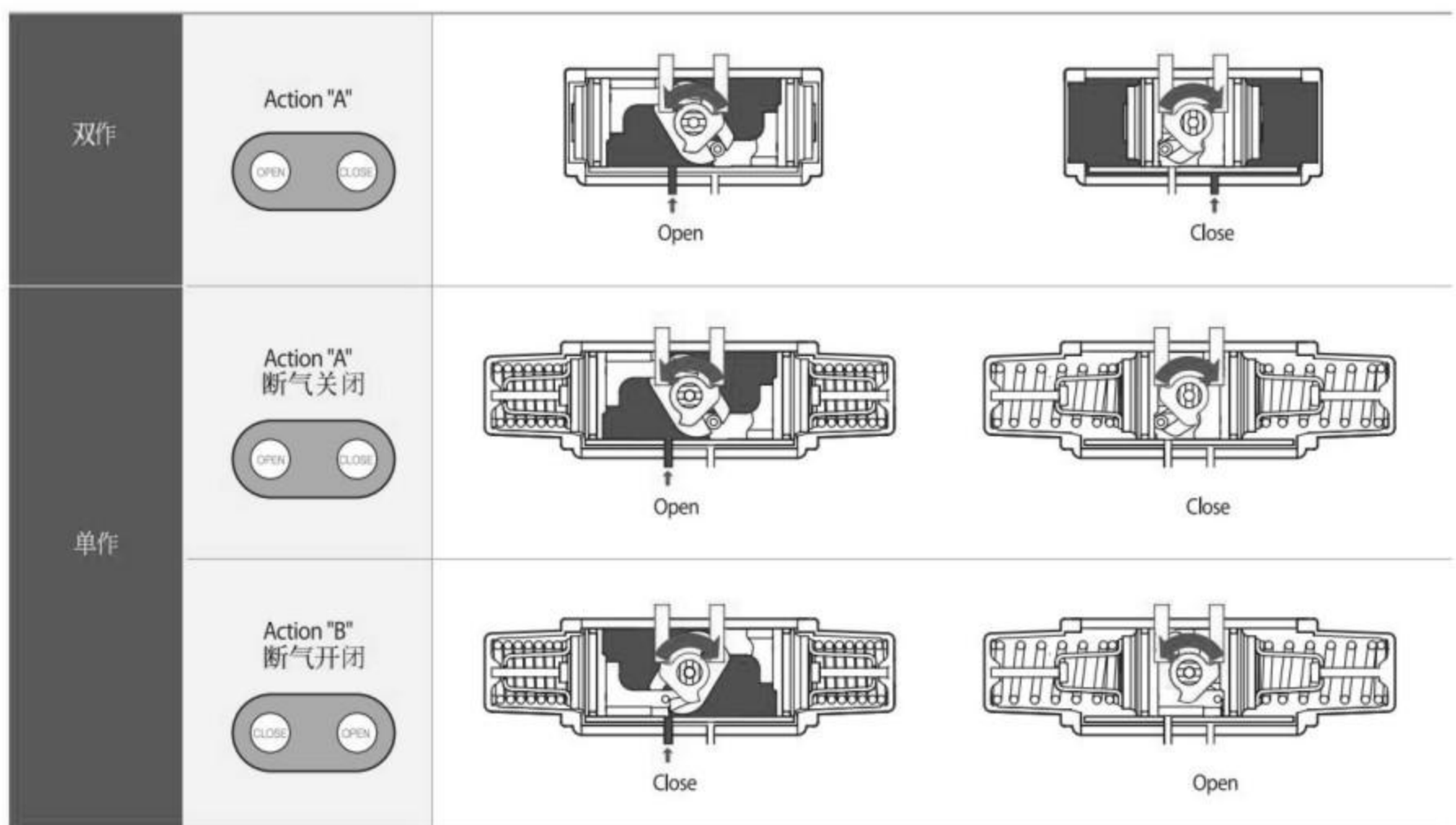

# 选型指南

## 内容

A series 拨叉式  
零件清单

A series 拨叉式  
选型指南  
尺寸表

A series 拨叉式  
扭矩表

R series 齿轮齿条  
零件清单

R series 齿轮齿条  
选型指南  
尺寸表

R series 齿轮齿条  
扭矩表

多种选择

限位开关

阀门尺寸		双作		单作	
		球阀	蝶阀	球阀	蝶阀
1/2"	15A	AD50		AS50	
3/4"	20A				
1"	25A				
1-1/4"	32A	AD65		AS65	
1-1/2"	40A				
2"	50A		AD50		AS80
2-1/2"	65A	AD80		AS100	AS50
3"	80A				AS65
4"	100A		AD65		AS125
5"	125A	AD100	AS140	AS80	
6"	150A	AD125	AS160		
8"	200A	AD140	AS185	AS100	
10"	250A	AD160	AS210		
12"	300A	AD185	AD125	AS250	AS140
14"	350A	AD210	AD140	AS300	AS160
16"	400A	AD250	AD160		AS185
18"	450A	AD300	AD185		AS210
20" ~ 22"	500A ~ 550A		AD210		AS250
24" ~ 32"	600A ~ 800A		AD250		AS300
34" ~ 40"	850A ~ 1000A		AD300		

\*基于 10K/#150。  
\*以上数据仅供参考，可能因阀门材料、压力、流体和使用环境而异。  
\*该数据不具有法律效力，不能作为法律依据。

# 尺寸表

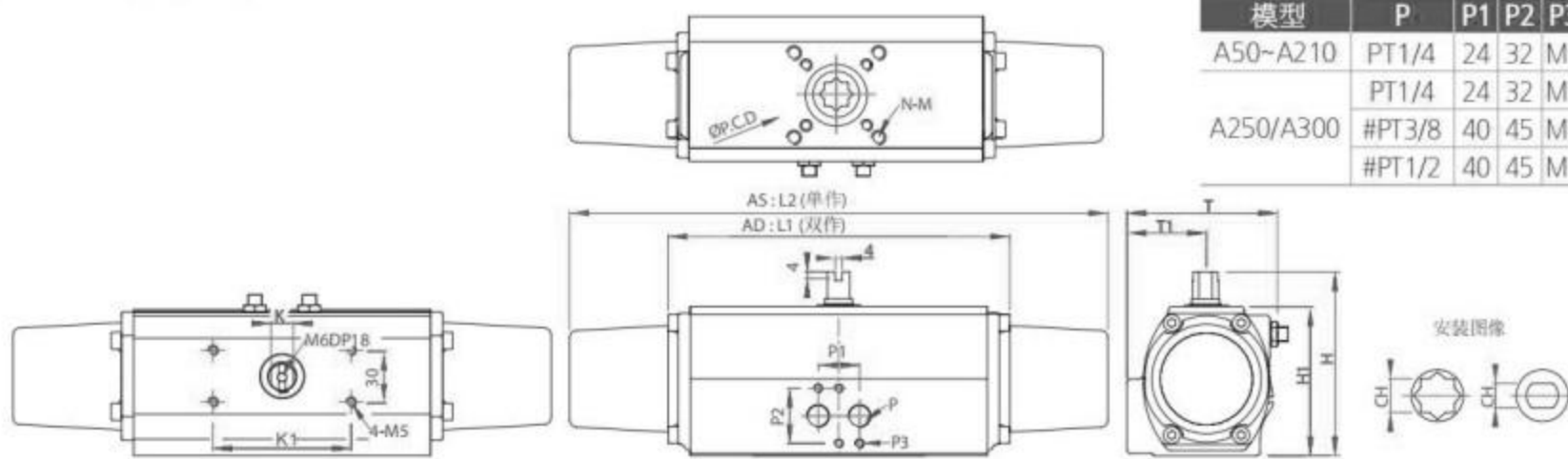

模型	P	P1	P2	P3
A50~A210	PT1/4	24	32	M5
	PT1/4	24	32	M5
A250/A300	#PT3/8	40	45	M6
	#PT1/2	40	45	M6

\*单元:mm

模型	K1	ISO	P.C.D (Ø)	N-G (深度)	K	AD L1	AS L2	T	T1	H	H1	CH	轴深度	AD 重量(Kg)	AS 重量(Kg)
A50	80	F03/F05/F07	36/50/70	4-M5/M6/M8 (10/12/12.5)	9	162	257	75	40	90	70	11*11	13	1.4	1.6
												#14*14	14		
												#9.7*Ø15	14		
A65	80	F05/F07	50/70	4-M6/M8 (14/14)	13	202	314	89	46	107	87	14*14	17	2.3	3.0
												#11*11	13		
												#11.7*Ø17	17		
A80	80	F07	70	4-M8(15)	13	253	421	101	49.5	126	106	17*17	19	3.9	5.3
												#14.7*Ø19	20		
												22*22	26		
A100	80	F07/F10	70/102	4-M8/M10 (16/19)	19	311	500	129	61.5	148	128	#17.7*Ø22	26	6.7	9.5
												22*22	26		
A125	80	F07/F10	70/102	4-M8/M10 (16/19)	19	390	606	151	71.5	174	154	22*22	26	11.3	17.6
A140	80	F10/F12	102/125	4-M10/M12 (18/26)	24	431	682	164	77	192	172	27*27	30	16.4	23.9
												#22*22			
A160	80	F14	140	4-M16(25)	24	506	781	188	89	216	196	36*36	38	23.7	36.6
		#F10/F12	#102/125	4-M10/M12 (18/26)								#27*27			
A185	80/130	F14	140	4-M16(26)	24	581	894	217	102	244	224	36*36	38	34.8	56.9
A210	130	F16	165	4-M20(30)	36	605	982	231	115	284	254	46*46	60	45.5	77.2
		#F14	140	4-M16(26)								#36*36			
A250	130	F16	165	4-M20(30)	36	755	1108	301	152	335	305	46*46	60	65.8	119.6
A300*	130	F16/F25	165/254	4-M20(30) /8-M16(23)	36	889	1345	372	170	408	378	55*55	60	165.0	275.5

\*A300阀体和端盖的材料为球墨铸铁。

#选项

# ► AD 系列 扭矩表

※单元: Nm

模型	角度	供气													
		3Bar		4Bar		4.5Bar		5Bar		6Bar		7Bar		8Bar	
		关	开	关	开	关	开	关	开	关	开	关	开	关	开
AD50	0°	25.8	24.0	35.6	32.4	39.4	36.2	44.9	39.9	53.4	47.3	64.0	54.5	71.1	60.4
	45°	13.9	13.6	18.5	17.9	21.1	20.3	23.2	21.9	28.2	27.3	33.6	31.9	37.9	36.0
	90°	22.9	24.9	31.3	33.8	35.5	38.6	39.2	43.6	47.7	50.3	55.4	62.6	61.4	68.4
AD65	0°	60.2	54.6	81.7	70.3	93.6	78.1	105.0	83.8	123.5	105.8	142.9	119.1	164.1	135.8
	45°	31.6	30.1	42.2	40.0	47.4	44.4	52.8	51.1	63.5	59.9	74.2	70.6	85.1	79.8
	90°	52.9	52.0	69.2	70.7	77.4	78.1	84.9	87.0	108.5	102.3	125.2	120.0	142.9	138.5
AD80	0°	120.0	100.5	160.5	135.8	182.6	152.6	203.7	169.3	244.3	206.4	288.4	239.0	333.4	264.6
	45°	65.3	51.2	85.6	71.4	95.3	82.0	105.8	90.0	127.0	110.3	147.3	130.5	165.8	148.2
	90°	107.6	97.0	142.0	135.8	158.8	156.1	174.6	165.8	211.7	201.1	246.1	238.1	275.2	273.4
AD100	0°	201.1	185.2	268.1	241.7	305.2	280.5	345.7	311.3	321.0	381.0	495.7	433.9	558.3	483.3
	45°	116.4	109.4	154.4	148.2	176.4	167.6	196.7	185.2	235.5	224.9	271.7	269.9	305.2	314.9
	90°	187.9	173.8	251.4	234.6	281.4	266.4	310.5	295.5	373.1	362.5	440.1	428.7	493.9	485.1
AD125	0°	493.9	430.4	618.3	589.2	703.8	650.0	778.8	716.2	952.6	834.4	1,118.4	949.0	1,300.1	1,108.7
	45°	234.6	225.8	310.5	304.3	350.2	345.7	388.1	382.8	491.3	456.0	541.5	541.5	613.0	608.6
	90°	382.8	357.2	510.7	479.8	572.4	538.9	631.5	601.5	781.5	718.8	904.1	849.4	1,001.1	965.8
AD140	0°	800.0	649.2	1,030.2	833.5	1,179.2	932.3	1,266.6	1,016.9	1,584.1	1,178.4	1,796.6	1,338.0	1,987.1	1,494.1
	45°	339.6	311.3	448.1	414.5	506.3	467.5	553.9	520.4	669.4	624.5	774.4	727.7	872.3	821.1
	90°	516.9	531.0	680.0	715.3	786.7	796.4	862.6	912.0	1,025.8	1,064.6	1,223.3	1,261.3	1,338.9	1,412.1
AD160	0°	1,094.6	912.0	1,487.1	1,173.9	1,698.7	1,316.8	1,932.5	1,447.4	2,294.1	1,724.3	2,758.9	2,142.4	3,261.6	2,424.6
	45°	486.0	480.7	654.4	637.7	735.6	718.8	821.1	799.1	977.3	994.0	1,149.2	1,138.7	1,285.1	1,281.5
	90°	765.6	1,098.1	1,009.0	1,195.1	1,140.4	1,284.2	1,263.9	1,412.1	1,496.8	1,688.1	1,837.2	1,936.9	2,033.9	2,232.3
AD185	0°	1,566.4	1,268.3	2,082.4	1,620.2	2,313.5	1,794.9	2,404.3	1,964.2	2,942.4	2,310.8	3,532.4	2,672.5	4,029.9	2,988.2
	45°	753.2	733.8	1,009.9	976.4	1,136.0	1,089.3	1,260.4	1,218.0	1,507.3	1,472.9	1,755.2	1,736.7	2,028.6	1,984.5
	90°	1,204.8	1,145.7	1,581.4	1,536.4	1,771.1	1,749.0	2,057.7	1,854.8	2,347.9	2,257.0	2,774.8	2,654.8	3,141.7	3,159.3
AD210	0°	2,090.3	1,781.6	2,831.2	2,266.7	3,219.3	2,540.2	3,625.0	2,804.8	4,462.9	3,272.2	5,300.8	3,748.5	6,209.3	4,233.6
	45°	970.2	1,093.7	1,296.5	1,420.0	1,464.1	1,578.8	1,631.7	1,746.4	1,966.9	2,072.7	2,310.8	2,416.7	2,663.6	2,760.7
	90°	1,508.2	1,816.9	2,019.8	2,425.5	1,993.3	2,716.6	2,504.9	2,998.8	2,998.8	3,625.0	3,501.5	4,268.9	3,977.8	4,868.6
AD250	0°	3,783.8	2,866.5	5,124.4	3,686.8	5,821.2	4,101.3	6,650.3	4,533.5	8,237.9	5,344.9	9,613.8	6,121.1	10,001.9	6,809.0
	45°	1,764.0	1,852.2	2,390.2	2,399.0	2,663.6	2,698.9	2,963.5	3,025.3	3,572.1	3,598.6	4,233.6	4,224.8	4,798.1	4,877.5
	90°	2,919.4	3,342.8	3,827.9	4,639.3	4,295.3	5,230.3	4,771.6	5,856.5	5,715.4	6,782.6	6,588.5	7,179.5	7,470.5	7,320.6
AD300	0°	5,450.8	4,965.7	7,426.4	6,421.0	8,334.9	7,108.9	9,322.7	7,788.1	11,421.9	9,181.6	13,256.5	10,407.6	15,311.5	11,642.4
	45°	3,087.0	3,475.1	4,145.4	4,621.7	4,683.4	5,186.2	5,221.4	5,759.5	6,271.0	6,853.1	7,329.4	7,973.3	8,370.2	9,067.0
	90°	4,939.2	5,680.1	6,500.3	7,611.7	7,294.1	8,643.6	8,070.3	9,569.7	9,596.2	11,836.4	11,122.0	12,744.9	12,595.0	13,124.2

※0° - 阀门关闭/90° - 阀门打开

# ► AS 系列 扭矩表

※单元：Nm

模型	弹簧	角度	供气 (气开式)							弹簧复位
			3Bar	4Bar	4.5Bar	5Bar	6Bar	7Bar	8Bar	
AS50	Weak	0°	15.9	24.4	27.2	31.0	40.8	52.2	56.5	10.1
		45°	7.9	12.5	14.8	17.1	21.8	27.0	31.5	6.7
		90°	10.1	19.3	22.9	27.0	36.6	44.9	54.0	13.0
	Middle*	0°	11.1	19.2	23.5	27.6	36.0	45.5	52.1	13.5
		45°	4.5	9.1	11.9	14.1	18.7	23.6	27.7	9.5
		90°	4.5	14.0	18.5	22.4	32.2	41.8	49.7	19.1
	Strong	0°	11.9	19.3	23.4	30.0	37.0	46.0	54.2	18.2
		45°	1.8	7.2	10.0	12.6	17.9	22.3	26.5	12.4
		90°	-	7.2	10.9	15.7	22.7	31.3	37.5	23.2
AS65	Weak	0°	34.6	52.8	60.2	71.0	88.1	106.1	124.8	23.9
		45°	15.8	28.0	33.6	38.5	49.8	59.6	69.5	15.4
		90°	20.7	39.3	48.8	57.9	76.0	91.0	110.8	27.9
	Middle*	0°	21.6	39.9	48.7	56.1	76.7	92.5	113.6	36.1
		45°	6.9	17.9	23.4	29.0	38.2	49.5	59.6	24.3
		90°	-	25.3	24.5	33.6	52.2	70.7	89.8	49.2
	Strong	0°	12.7	31.7	40.3	51.8	67.9	85.0	105.5	45.6
		45°	-	9.5	14.7	20.6	31.3	42.5	53.9	32.1
		90°	-	-	9.3	18.6	37.3	55.1	65.5	66.1
AS80	Weak	0°	84.7	122.9	142.4	161.1	198.3	234.6	270.9	42.8
		45°	40.0	61.4	72.6	82.9	103.3	123.8	145.2	25.8
		90°	41.0	75.4	95.9	111.7	147.1	186.2	229.0	48.4
	Middle*	0°	43.8	80.1	104.3	122.9	159.2	197.4	234.6	69.8
		45°	9.3	28.9	40.0	54.0	75.4	95.9	118.2	48.4
		90°	-	37.2	56.8	74.5	113.6	151.8	212.3	95.9
	Strong	0°	20.5	59.6	79.1	95.9	139.7	176.9	212.3	95.0
		45°	-	11.2	25.1	37.2	56.8	77.3	99.6	66.1
		90°	-	-	20.5	39.1	74.5	109.9	147.1	130.3
AS100	Weak	0°	115.4	180.6	229.0	255.1	310.0	373.3	425.5	80.1
		45°	46.6	93.1	111.7	128.5	172.2	217.9	265.3	60.5
		90°	64.2	130.3	162.9	195.5	260.7	325.9	389.2	121.0
	Middle*	0°	77.3	144.3	176.9	207.6	271.9	332.4	412.4	112.7
		45°	14.0	60.5	81.9	100.5	141.5	179.7	233.7	85.7
		90°	-	70.8	102.4	135.0	202.0	270.0	353.8	164.8
	Strong	0°	49.3	121.0	150.8	186.2	257.9	317.5	375.2	147.1
		45°	-	40.0	60.5	81.9	120.1	161.1	205.8	112.7
		90°	-	24.2	58.7	91.2	159.2	230.9	293.3	240.2
AS125	W	0°	251.4	381.7	461.8	521.4	643.3	767.1	883.5	166.6
		45°	126.6	205.8	243.9	285.8	362.2	442.2	517.6	101.5
		90°	184.3	324.9	388.2	459.0	599.6	745.7	886.3	185.3
	WM	0°	203.0	333.3	400.3	461.8	582.8	702.9	827.7	243.0
		45°	83.8	166.6	203.9	243.0	324.9	398.5	474.8	147.1
		90°	91.2	220.6	288.6	356.6	497.2	634.0	775.5	283.0
	WS	0°	171.3	302.6	365.0	424.5	554.9	675.0	796.9	283.0
		45°	59.6	143.4	182.5	220.6	298.9	377.1	455.3	172.2
		90°	43.8	180.6	251.4	316.5	455.3	593.0	732.7	315.6
	M	0°	152.7	287.7	351.0	412.4	544.6	669.4	795.1	302.6
		45°	41.9	128.5	170.4	205.8	280.2	357.5	432.9	190.9
		90°	-	133.1	200.2	262.5	399.4	538.1	679.6	372.4
	MS	0°	119.2	248.6	314.7	378.9	501.8	652.6	773.7	354.7
		45°	18.6	100.5	138.7	176.9	256.0	331.4	405.9	215.1
		90°	-	85.7	148.0	215.1	348.2	485.1	623.8	417.1
	S*	0°	72.6	203.9	270.0	334.2	470.2	599.6	721.5	396.6
		45°	-	71.7	108.9	149.0	226.2	305.4	381.7	240.2
		90°	-	41.9	107.1	173.2	304.4	441.3	580.0	461.8

※0° - 阀门关闭/90° - 阀门打开

\*Standard

## 内容

A series 拨叉式  
零件清单

A series 拨叉式  
选型指南  
尺寸表

A series 拨叉式  
扭矩表

R series 齿轮齿条  
零件清单

R series 齿轮齿条  
选型指南  
尺寸表

R series 齿轮齿条  
扭矩表

多种选择

限位开关

※单元：Nm

模型	弹簧	角度	供气 (气开式)							弹簧复位	
			3Bar	4Bar	4.5Bar	5Bar	6Bar	7Bar	8Bar		
AS140	W	0°	499.4	701.1	797.1	888.4	1,094.9	1,272.5	1,394.5	144.1	
		45°	244.9	360.2	413.0	470.6	581.0	696.3	806.7	91.2	
		90°	374.6	561.8	662.7	758.7	960.4	1,166.9	1,378.2	182.5	
	WM	0°	356.3	553.2	652.1	753.0	982.5	1,169.8	1,348.4	267.0	
		45°	169.0	276.6	332.3	388.0	500.4	613.7	727.0	164.2	
		90°	223.8	404.3	501.3	595.4	796.2	999.8	1,197.6	311.2	
	WS	0°	331.3	538.8	654.0	739.5	957.5	1,143.8	1,318.6	330.4	
		45°	132.5	251.6	312.1	370.7	486.9	604.1	716.5	204.6	
		90°	133.5	338.1	430.3	530.1	727.0	927.7	1,127.5	386.1	
	M	0°	249.7	465.8	568.6	663.6	871.1	1,078.5	1,156.3	397.6	
		45°	91.2	212.2	266.0	314.1	426.4	556.1	665.6	236.3	
		90°	77.8	284.3	376.5	477.3	690.5	875.9	1,075.6	450.4	
	MS	0°	312.1	423.5	506.1	605.1	803.9	990.2	1,169.8	458.1	
		45°	48.0	161.3	222.8	285.2	397.6	512.9	616.6	274.7	
		90°	-	176.7	274.7	375.5	575.3	839.4	950.8	529.2	
	S*	0°	172.9	379.4	475.4	571.4	768.3	960.4	1,162.1	566.6	
		45°	14.4	139.3	196.9	259.3	374.6	489.8	600.3	321.7	
		90°	-	100.8	196.9	297.7	489.8	691.5	888.4	600.3	
	AS160	W	0°	649.8	964.5	1,141.4	1,289.4	1,596.7	1,896.4	2,194.4	343.5
			45°	307.2	475.7	560.5	647.0	812.8	983.1	1,167.5	202.0
			90°	452.5	749.5	900.3	1,066.0	1,338.8	1,642.3	1,967.2	379.8
WM		0°	601.4	915.2	1,055.8	1,202.9	1,576.2	1,864.8	2,090.1	422.7	
		45°	284.0	450.6	534.4	621.0	784.8	952.4	1,120.0	244.9	
		90°	391.0	683.4	848.1	1,002.7	1,336.0	1,589.2	1,830.3	463.6	
WS		0°	418.0	703.8	863.0	993.4	1,382.5	1,655.3	1,875.0	559.5	
		45°	151.8	326.8	405.9	494.4	672.2	839.8	1,015.7	332.4	
		90°	142.4	462.7	618.2	760.6	1,053.9	1,366.7	1,689.8	662.9	
M		0°	528.8	841.6	982.2	1,152.6	1,509.2	1,878.8	2,143.2	472.9	
		45°	230.9	404.1	489.7	571.6	745.7	918.0	1,081.8	277.4	
		90°	296.1	600.5	756.9	896.6	1,189.8	1,458.9	1,726.1	525.1	
MS		0°	355.6	656.4	824.9	978.5	1,323.9	1,631.1	1,862.9	654.5	
		45°	109.9	283.0	366.8	459.0	629.4	805.3	969.2	388.2	
		90°	133.1	365.9	490.6	632.1	955.2	1,258.7	1,525.0	767.1	
S*		0°	210.4	509.3	655.4	797.9	1,136.8	1,418.8	1,716.8	842.6	
		45°	-	191.8	277.4	367.7	533.5	703.8	864.0	498.1	
		90°	-	161.1	323.1	463.6	749.5	1,064.1	1,328.5	952.4	
AS185		W	0°	951.5	1,317.4	1,511.0	1,713.0	2,105.9	2,395.5	2,794.9	386.4
			45°	484.1	745.7	872.3	1,002.7	1,289.4	1,549.2	1,818.2	260.7
			90°	656.4	1,064.1	1,273.6	1,458.9	1,820.1	2,220.4	2,676.6	492.5
	WM	0°	727.1	1,108.8	1,371.4	1,539.9	1,891.8	2,282.8	2,630.1	626.6	
		45°	333.3	606.1	742.0	864.9	1,118.1	1,409.5	1,686.0	420.8	
		90°	369.6	765.3	970.1	1,177.7	1,645.1	1,930.0	2,424.3	769.9	
	WS	0°	506.5	895.6	1,113.5	1,337.8	1,718.6	2,081.7	2,518.4	911.4	
		45°	171.3	444.1	584.7	713.1	978.5	1,231.7	1,501.7	567.0	
		90°	18.6	485.1	703.8	899.3	1,318.3	1,679.5	2,100.3	1,074.4	
	M	0°	468.3	886.3	1,130.2	1,313.6	1,689.8	2,098.5	2,370.3	902.1	
		45°	177.8	442.2	566.0	693.6	951.5	1,215.9	1,490.5	592.1	
		90°	-	468.3	671.3	877.0	1,287.6	1,689.8	2,079.9	1,157.2	
	MS	0°	319.3	751.3	935.7	1,123.7	1,510.1	1,911.3	2,303.3	1,087.4	
		45°	28.9	300.7	451.5	590.3	833.2	1,101.4	1,376.0	726.2	
		90°	-	209.5	432.0	637.7	1,035.3	1,417.9	1,897.4	1,394.6	
	S*	0°	138.7	606.1	817.4	1,010.1	1,446.8	1,819.2	2,194.4	1,336.9	
		45°	-	156.4	289.5	417.1	674.0	990.6	1,215.9	869.6	
		90°	-	-	169.4	382.6	795.7	1,242.0	1,652.5	1,654.4	

※0° - 阀门关闭/90° - 阀门打开

\*Standard

内容

A series 拨叉式  
零件清单

A series 拨叉式  
选型指南  
尺寸表

A series 拨叉式  
扭矩表

R series 齿轮齿条  
零件清单

R series 齿轮齿条  
选型指南  
尺寸表

R series 齿轮齿条  
扭矩表

多种选择

限位开关

内容

A series 拨叉式  
零件清单

A series 拨叉式  
选型指南  
尺寸表

A series 拨叉式  
扭矩表

R series 齿轮齿条  
零件清单

R series 齿轮齿条  
选型指南  
尺寸表

R series 齿轮齿条  
扭矩表

多种选择

限位开关

\*单元: Nm

模型	弹簧	角度	供气 (气开式)							弹簧复位
			3Bar	4Bar	4.5Bar	5Bar	6Bar	7Bar	8Bar	
AS210	W	0°	1,443.1	1,955.1	2,290.3	2,495.1	3,025.8	3,556.4	4,124.3	335.2
		45°	837.9	1,191.7	1,359.3	1,536.2	1,889.9	2,253.0	2,597.5	214.1
		90°	1,182.4	1,713.0	2,001.7	2,318.2	2,895.4	3,472.6	4,105.7	400.3
	WM	0°	1,080.0	1,601.3	1,880.6	2,150.6	2,699.9	3,193.3	3,724.0	744.8
		45°	558.6	921.7	1,107.9	1,275.5	1,787.5	1,973.7	2,299.6	456.2
		90°	744.8	1,340.6	1,647.9	1,964.4	2,588.2	3,230.6	3,826.4	875.1
	WS	0°	986.9	1,564.1	1,834.1	2,066.8	2,644.0	3,212.0	3,742.6	977.6
		45°	437.6	800.7	977.6	1,154.4	1,489.6	1,852.7	2,206.5	540.0
		90°	465.5	1,005.5	1,377.9	1,666.5	2,271.6	2,942.0	3,519.2	1,042.7
	M	0°	623.8	1,173.1	1,405.8	1,666.5	2,187.9	2,718.5	3,193.3	1,182.4
		45°	288.6	670.3	865.8	1,033.4	1,405.8	1,787.5	2,197.2	698.3
		90°	167.6	791.4	1,098.6	1,387.2	2,048.2	2,662.7	3,314.4	1,331.3
	MS	0°	586.5	1,163.8	1,461.7	1,750.3	2,290.3	2,802.3	3,314.4	1,387.2
		45°	195.5	540.0	726.2	893.8	1,247.5	1,601.3	1,973.7	810.0
		90°	-	558.6	884.5	1,191.7	1,815.5	2,448.5	3,165.4	1,536.2
S*	0°	297.9	837.9	1,117.2	1,387.2	1,973.7	2,495.1	2,979.2	1,601.3	
	45°	-	400.3	586.5	763.4	1,154.4	1,526.8	1,899.2	958.9	
	90°	-	270.0	567.9	847.2	1,452.4	2,076.1	2,662.7	1,778.2	
AS250	W	0°	2,364.7	3,314.4	3,798.5	4,301.2	5,213.6	6,116.7	6,936.0	763.4
		45°	1,340.6	1,955.1	2,346.1	2,634.7	3,277.1	3,891.6	4,487.4	391.0
		90°	2,392.7	3,593.7	4,170.9	4,785.3	5,455.7	6,079.4	8,472.1	754.1
	WM	0°	1,787.5	2,755.8	3,258.5	3,733.3	4,673.6	5,576.7	6,451.8	1,461.7
		45°	1,024.1	1,629.3	1,936.5	2,253.0	2,876.8	3,509.9	4,133.6	763.4
		90°	1,601.3	2,746.5	3,351.6	3,910.2	5,101.9	6,312.2	7,587.7	1,387.2
	WS	0°	1,508.2	2,513.7	3,007.1	3,454.0	4,431.6	5,371.9	6,274.9	1,768.9
		45°	791.4	1,433.7	1,750.3	2,048.2	2,662.7	3,286.4	3,891.6	940.3
		90°	1,033.4	2,169.2	2,709.2	3,267.8	4,403.6	5,595.3	6,805.6	1,796.8
	M	0°	1,508.2	2,616.1	3,165.4	3,668.1	4,627.1	5,539.5	6,405.3	1,908.6
		45°	716.9	1,368.6	1,675.8	1,973.7	2,588.2	3,230.6	3,817.1	1,042.7
		90°	800.7	1,983.0	2,578.9	3,156.1	4,366.4	5,586.0	6,740.4	2,020.3
	MS	0°	1,145.1	2,132.0	2,625.4	3,100.2	4,068.5	5,008.8	5,828.1	2,364.7
		45°	353.8	986.9	1,303.4	1,592.0	2,215.8	2,848.9	3,463.3	1,396.5
		90°	232.8	1,284.8	1,862.0	2,457.8	3,565.7	4,627.1	5,781.5	2,448.5
S*	0°	958.9	2,011.0	2,485.8	2,988.5	3,789.2	4,701.6	4,617.8	2,653.4	
	45°	270.0	893.8	1,201.0	1,508.2	2,132.0	2,755.8	3,416.8	1,536.2	
	90°	46.6	1,033.4	1,601.3	2,253.0	3,295.7	4,506.0	5,567.4	3,035.1	
AS300	W	0°	4,394.3	6,126.0	6,908.0	7,755.2	9,216.9	10,576.2	11,963.4	1,368.6
		45°	2,718.5	3,910.2	4,515.4	5,111.2	6,274.9	7,429.4	8,583.8	698.3
		90°	4,319.8	6,330.8	7,354.9	8,397.6	9,915.2	10,762.4	11,311.7	1,322.0
	WM	0°	3,444.7	5,111.2	5,874.6	6,638.0	8,192.8	9,663.8	10,985.8	2,457.8
		45°	2,011.0	3,230.6	3,733.3	4,375.7	5,539.5	6,731.1	7,839.0	1,359.3
		90°	2,709.2	4,664.3	5,697.7	6,721.8	8,825.9	10,436.5	10,855.5	2,644.0
	WS	0°	2,550.9	4,143.0	4,971.5	5,818.8	7,503.9	8,993.5	9,570.7	3,696.1
		45°	1,377.9	2,541.6	3,146.8	3,733.3	4,887.8	6,051.5	7,196.6	1,880.6
		90°	1,489.6	3,547.1	4,580.5	6,014.3	7,801.8	9,570.7	10,408.6	3,333.0
	M	0°	2,448.5	4,236.1	5,083.3	5,902.5	7,448.0	8,928.3	10,092.0	3,956.8
		45°	1,070.7	2,308.9	2,867.5	3,454.0	4,589.8	5,809.4	6,898.7	2,150.6
		90°	1,145.1	3,090.9	4,105.7	5,092.6	7,029.1	8,984.2	10,110.7	3,956.8
	MS	0°	1,964.4	3,565.7	4,338.5	5,213.6	6,814.9	8,379.0	9,701.0	4,729.5
		45°	651.7	1,834.1	2,346.1	3,007.1	4,254.7	5,353.3	6,451.8	2,476.5
		90°	409.6	2,383.4	3,137.5	4,236.1	6,535.6	8,146.3	9,989.6	4,552.6
S*	0°	1,247.5	3,100.2	4,096.4	4,943.6	6,619.4	8,313.8	9,645.2	5,818.8	
	45°	-	1,266.2	1,843.4	2,355.4	3,537.8	4,757.4	5,939.8	3,165.4	
	90°	-	958.9	1,899.2	2,839.6	4,925.0	7,038.4	9,086.6	5,744.3	

\*0° - 阀门关闭/90° - 阀门打开

\*Standard

# 零件

内容

- A series 拨叉式零件清单
- A series 拨叉式选型指南尺寸表
- A series 拨叉式扭矩表
- R series 齿轮齿条零件清单
- R series 齿轮齿条选型指南尺寸表
- R series 齿轮齿条扭矩表
- 多种选择
- 限位开关

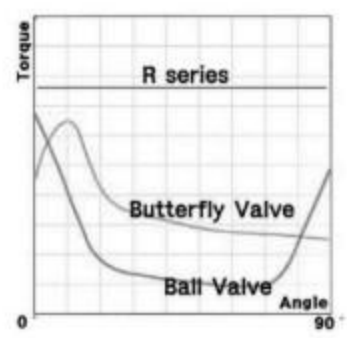
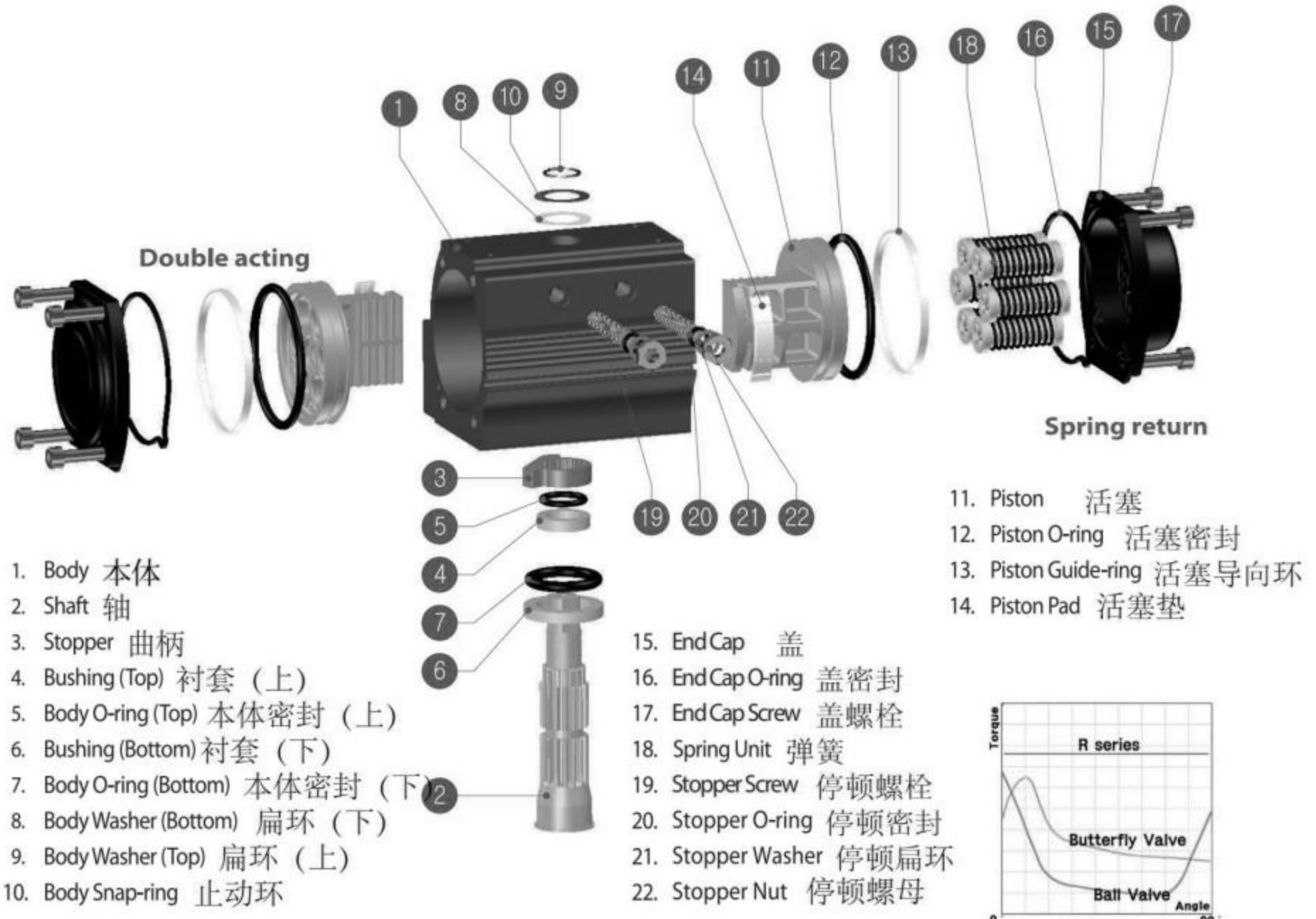

# 运行机制

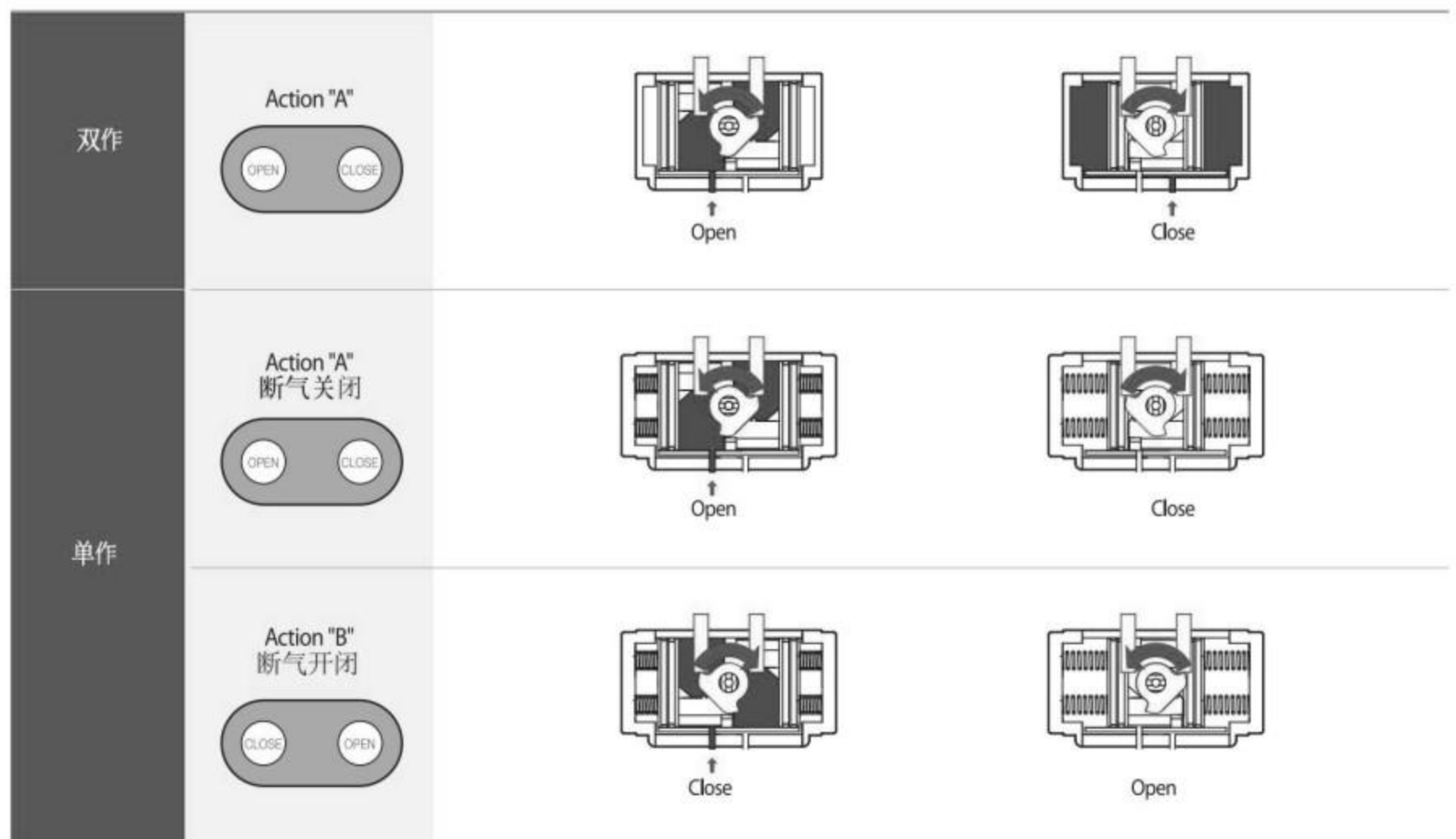

# 选型指南

阀门尺寸		双作		单作	
		球阀	蝶阀	球阀	蝶阀
1/2"	15A	RD32 (1piece)	RD50	RS40	
3/4"	20A	RD40 (1piece)		RS50	
1"	25A		RD65	RS65	
1-1/4"	32A			RS80	
1-1/2"	40A		RD80	RS90	RS50
2"	50A			RS100	RS65
2-1/2"	65A		RD90	RS115	RS80
3"	80A	RD100 / RD115		RS125	RS90
4"	100A	RD115 / RD125	RD80	RS140	RS100
5"	125A	RD140		RS160 / RS185	RS115
6"	150A	RD160	RD100	RS185 / RS210	RS125
8"	200A	RD185	RD125		RS140
10"	250A	RD210	RD140		RS160
12"	300A		RD160		RS185
14"	350A		RD185		RS210
16"	400A		RD210		

\*基于 10K/#150。  
 \*以上数据仅供参考，可能因阀门材料、压力、流体和使用环境而异。  
 \*该数据不具有法律效力，不能作为法律证据。

# 尺寸表

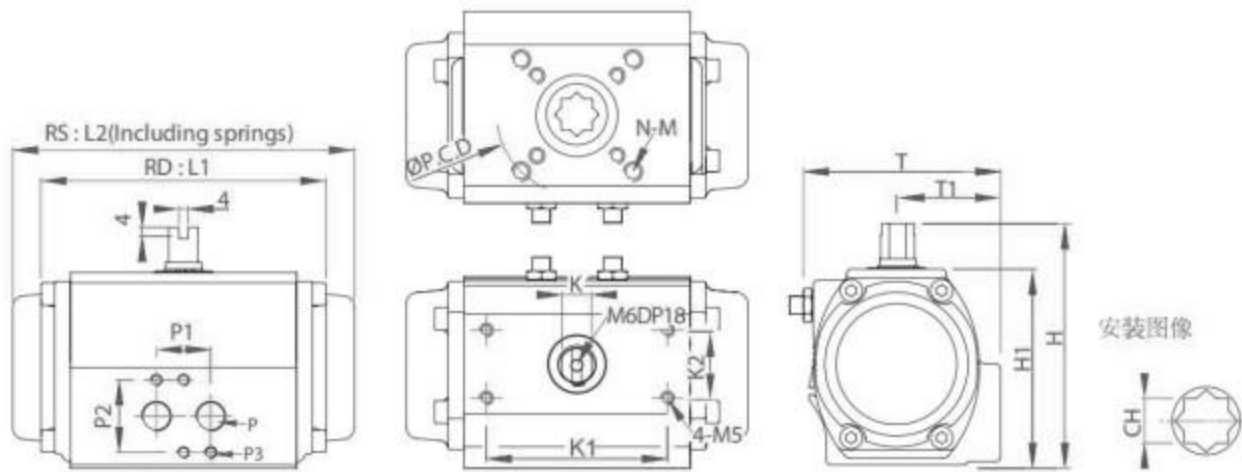

模型	P	P1	P2	P3
R32,R40	PT1/8	24	32	M5
R50~R210	PT1/4	24	32	M5

	K1	K2
R32	25,5	25,5
R40	50	25
R50~R185	80	30
R210	130	30

\*单元:mm

模型	ISO	P.C.D (Ø)	N-G (深度)	K	RD L1	RS L2	T	T1	H	H1	CH	轴深度	RD 重量(Kg)	RS 重量(Kg)
@RD32	F03	36	4-M5(7)	7	66	-	45	25	55	45	9*9	9	0.3	-
@R40	F03/F05	36/50	4-M5/M6 (8/12)	9	97	97	63	32	75	55	9*9	9	0.5	0.6
	#F04	#42	#4-M5											
R50	F03/F05/F07	36/50/70	4-M5/M6/M8 (10/12/12.5)	9	119	133	75	40	90	70	11*11	13	1.0	1.1
	#F04	#42	#4-M5											
R65	F05/F07	50/70	4-M6/M8 (11/11)	13	131	154	89	46	106.5	86.5	14*14	16	1.4	1.5
	#F07	#70	#4-M5											
R80	F05/F07	50/70	4-M6/M8 (11/15)	19	189	220	101	49.5	126	106	17*17	19	2.9	3.3
R90	F07	70	4-M8(17)	19	188	223	104	54.5	136	116	17*17	19	3.4	3.8
R100	F07/F10	70/102	4-M8/M10 (16/19)	19	229	256	132	61.5	148	128	22*22 #17*17	26 19	4.7	5.4
R115	F07/F10	70/102	4-M8/M10 (16/19)	19	264	302	141.5	67.5	163	143	22*22	26	6.7	5.4
R125	F07/F10	70/102	4-M8/M10 (16/19)	19	299	330	151	71.5	174	154	22*22	26	8.6	9.9
R140	F10/F12	102/125	4-M10/M12 (18/25)	24	332	389	164	77	192	172	27*27 #22*22	30 26	12.4	14.5
R160	F10/F12	102/125	4-M10/M12 (18/25)	24	364	416	188	103.5	216	196	27*27	30	16.9	19.5
R185	F10/F12	102/125	4-M10/M12 (18/25)	24	434	465	217	103	244	224	36*36	30	24.2	29.0
R210	F14	140	4-M16(23)	36	444	527	231	115	284	254	36*36	30	32.3	37.9

#选项

## 内容

A series 拨叉式零件清单

A series 拨叉式选型指南尺寸表

A series 拨叉式扭矩表

R series 齿轮齿条零件清单

R series 齿轮齿条选型指南尺寸表

R series 齿轮齿条扭矩表

多种选择

限位开关

# ► RD 系列 扭矩表

※单元：Nm

模型	供气						
	3Bar	4Bar	4.5Bar	5Bar	6Bar	7Bar	8Bar
RD32	2.0	3.0	3.4	3.8	4.7	5.6	6.6
RD40	4.8	6.6	7.5	8.3	10.1	11.9	13.6
RD50	8.8	12.1	13.9	15.2	18.2	21.6	24.4
RD65	16.5	21.8	24.8	27.3	33.2	38.5	44.1
RD80	35.4	49.3	55.9	63.3	76.3	91.2	107.1
RD90	44.7	63.3	71.7	81.0	98.7	117.3	139.7
RD100	70.8	95.9	109.9	122.0	148.0	176.0	203.0
RD115	113.6	156.4	176.0	195.5	236.5	277.4	314.7
RD125	156.4	210.4	237.4	265.3	317.5	375.2	424.5
RD140	246.7	327.7	365.9	407.8	485.1	566.0	630.3
RD160	339.8	450.6	509.3	566.0	676.8	788.6	901.2
RD185	449.7	596.8	675.9	748.5	907.7	1,060.4	1,203.8
RD210	642.4	844.4	949.6	1,052.0	1,263.4	1,487.7	1,736.3

※0° - 阀门关闭/90° - 阀门打开

内容

A series 拨叉式  
零件清单

A series 拨叉式  
选型指南  
尺寸表

A series 拨叉式  
扭矩表

R series 齿轮齿条  
零件清单

R series 齿轮齿条  
选型指南  
尺寸表

R series 齿轮齿条  
扭矩表

多种选择

限位开关

# ► RS 系列 扭矩表

※单元: Nm

模型	弹簧	供气 (气开式)															
		3Bar		4Bar		4.5Bar		5Bar		6Bar		7Bar		8Bar		弹簧复位	
		0°	90°	0°	90°	0°	90°	0°	90°	0°	90°	0°	90°	0°	90°	90°	0°
RS40	WM	3.3	0.5	5.0	1.3	5.9	1.9	6.8	2.2	8.7	3.2	10.5	4.3	12.4	5.3	2.4	1.4
	WS	2.6	-	4.4	0.7	5.3	1.3	6.1	1.7	8.0	2.7	9.8	3.5	11.5	4.3	3.3	1.9
	M	2.3	-	4.2	0.7	5.1	1.1	5.9	1.6	7.7	2.3	9.5	3.2	11.3	4.0	3.7	2.3
	MS	1.9	-	3.5	0.3	4.5	0.8	5.3	1.3	7.2	2.1	9.0	2.9	10.8	3.7	4.6	2.9
	S*	1.5	-	3.1	-	4.0	-	4.9	0.7	6.6	1.4	8.5	2.0	10.2	2.7	5.1	3.2
RS50	4	7.0	4.6	10.2	7.9	11.8	9.6	13.4	11.2	16.5	14.4	19.1	17.5	22.0	20.8	2.5	1.8
	5	6.3	4.3	9.6	7.6	11.2	9.2	12.7	10.7	15.9	14.6	18.6	17.2	21.4	20.3	3.6	2.0
	6	5.7	3.4	8.9	6.3	10.7	8.0	12.1	9.7	15.1	12.9	18.3	16.0	21.2	19.2	4.5	2.6
	7	5.2	2.3	8.4	5.6	10.0	7.2	11.6	8.8	14.5	11.9	17.4	15.2	20.3	18.3	4.8	3.1
	8*	4.8	1.6	7.9	4.7	9.6	6.3	11.1	7.9	14.1	11.1	17.2	14.2	20.2	17.4	5.4	3.6
	9	4.3	0.7	7.3	3.8	8.9	5.4	10.7	7.1	13.8	10.0	17.0	13.4	19.7	16.6	6.5	3.9
	10	3.8	-	7.0	2.8	8.6	4.4	10.1	6.1	13.4	9.3	16.0	12.5	19.1	15.7	7.2	4.6
	11	3.1	-	6.4	2.2	8.0	3.8	9.6	5.4	12.6	8.6	15.6	11.9	18.7	14.9	8.2	5.0
	12	2.7	-	5.8	1.4	7.5	2.7	9.0	4.3	12.1	7.6	15.3	10.8	18.0	13.9	9.0	5.5
RS65	4	11.3	8.2	17.1	13.8	19.3	16.7	22.0	19.5	27.5	25.2	33.1	31.0	38.4	36.9	6.8	4.0
	5	10.1	6.5	15.7	12.5	18.3	15.1	21.1	18.0	26.8	23.4	32.2	29.1	38.0	34.8	9.1	5.3
	6	8.8	4.5	14.6	10.3	17.3	13.2	20.2	16.0	25.6	21.8	31.2	27.9	36.6	33.5	10.8	6.5
	7	7.6	2.7	13.2	8.1	16.5	11.0	18.9	14.0	24.4	19.6	29.9	25.5	35.5	31.0	12.6	7.5
	8*	6.3	-	12.5	6.5	15.1	9.1	17.4	11.9	23.0	17.6	28.5	23.4	34.0	28.4	14.6	8.9
	9	5.0	-	10.7	4.4	13.7	7.3	16.4	10.2	22.3	15.7	28.1	21.6	32.6	27.4	15.9	10.4
	10	3.6	-	9.5	2.3	12.2	5.1	15.0	8.0	20.9	13.7	26.7	19.5	32.0	25.2	18.6	11.9
RS80	4	31.7	24.9	46.0	39.0	53.4	46.8	59.8	54.1	74.9	68.2	89.7	83.0	109.1	97.0	14.8	8.8
	5	29.0	19.8	43.0	34.4	50.5	41.5	57.6	48.5	71.8	63.8	86.8	78.3	105.4	92.0	18.7	11.0
	6	26.1	15.7	40.4	30.6	48.7	38.3	54.9	45.3	69.6	59.9	84.0	74.7	101.8	88.3	22.8	13.9
	7	23.0	10.9	38.2	25.1	45.7	32.7	52.1	39.2	66.5	54.2	83.9	69.7	99.4	82.7	27.7	15.9
	8*	19.9	5.9	35.3	20.8	42.3	28.9	49.5	35.4	64.0	50.1	77.6	65.5	93.5	78.3	32.0	18.4
	9	17.2	2.1	31.8	16.1	39.2	23.5	46.3	30.7	60.9	46.5	76.2	60.6	89.6	73.8	36.2	21.3
RS80	10	14.6	-	29.1	12.2	36.6	18.7	44.2	26.7	58.5	41.1	73.2	55.8	86.3	68.1	40.7	24.7
	11	11.4	-	26.2	6.4	33.4	14.3	40.8	21.1	55.3	35.8	70.1	50.7	83.4	64.1	45.2	26.8
	12	9.3	-	23.1	-	30.4	9.6	37.9	16.4	52.8	31.3	67.0	46.4	80.6	61.2	49.5	29.2

※0° - 阀门关闭/90° - 阀门打开

\*Standard

内容

A series 拨叉式  
零件清单

A series 拨叉式  
选型指南  
尺寸表

A series 拨叉式  
扭矩表

R series 齿轮齿条  
零件清单

R series 齿轮齿条  
选型指南  
尺寸表

R series 齿轮齿条  
扭矩表

多种选择

限位开关

※单元: Nm

模型	弹簧	供气 (气开式)															
		3Bar		4Bar		4.5Bar		5Bar		6Bar		7Bar		8Bar		弹簧复位	
		0°	90°	0°	90°	0°	90°	0°	90°	0°	90°	0°	90°	0°	90°	90°	0°
RS90	4	39.1	27.9	57.7	47.5	66.1	56.8	76.3	66.1	95.0	84.7	113.6	103.3	132.2	121.0	17.7	9.3
	5	34.4	19.6	52.1	38.2	61.4	47.5	70.8	58.7	91.2	76.3	108.0	96.8	126.6	116.4	24.2	13.0
	6	31.7	17.7	49.3	33.5	59.6	43.8	68.0	52.1	87.5	69.8	108.0	88.4	123.8	108.9	29.8	17.7
	7	28.9	7.4	45.6	26.1	55.9	34.4	65.2	44.7	83.8	63.3	102.4	81.9	120.1	102.4	33.5	20.5
	8*	24.2	-	42.8	19.6	52.1	28.9	61.4	38.2	80.1	55.9	95.9	75.4	115.4	94.0	40.0	22.3
	9	22.3	-	41.0	18.6	51.2	27.0	60.5	35.4	78.2	54.0	96.8	72.6	111.7	89.4	46.6	26.1
	10	20.5	-	38.2	13.0	47.5	21.4	56.8	31.7	75.4	50.3	92.2	68.9	108.0	81.0	53.1	27.9
	11	16.8	-	36.3	-	43.8	14.9	53.1	22.3	72.6	42.8	90.3	62.4	107.1	81.9	55.9	31.7
	12	14.0	-	29.8	-	39.1	8.4	50.3	14.9	66.1	33.5	84.7	54.9	105.2	72.6	61.4	35.4
RS100	4	55.9	35.4	81.0	62.4	94.0	74.5	106.1	88.4	132.2	114.5	158.3	141.5	184.3	168.5	31.7	17.7
	5	50.3	25.1	75.4	52.1	88.4	65.2	100.5	77.3	126.6	104.3	152.7	131.3	177.8	157.3	40.0	22.3
	6	48.4	22.3	73.5	46.6	85.7	59.6	98.7	71.7	124.8	98.7	149.9	125.7	175.0	151.8	47.5	27.0
	7	41.9	-	67.0	34.4	79.1	47.5	93.1	59.6	117.3	87.5	144.3	113.6	170.4	136.9	55.9	29.8
	8*	36.3	-	61.4	24.2	74.5	37.2	87.5	50.3	113.6	78.2	139.7	104.3	164.8	130.3	67.0	37.2
	9	29.8	-	55.9	9.3	68.0	27.9	81.0	41.0	107.1	67.0	133.1	93.1	159.2	120.1	75.4	44.7
	10	24.2	-	48.4	-	62.4	22.3	76.3	34.4	100.5	58.7	126.6	84.7	151.8	110.8	84.7	50.3
	11	18.6	-	44.7	-	56.8	-	69.8	21.4	95.0	48.4	121.0	73.5	146.2	100.5	93.1	53.1
	12	13.0	-	39.1	-	51.2	-	64.2	13.0	90.3	38.2	115.4	64.2	141.5	87.5	103.3	58.7
RS115	4	99.6	86.6	143.4	126.6	163.9	146.2	183.4	167.6	226.2	210.4	268.1	251.4	312.8	298.9	32.6	18.6
	5	95.0	71.7	138.7	116.4	157.3	138.7	178.8	156.4	219.7	198.3	260.7	240.2	308.2	288.6	45.6	26.1
	6	87.5	59.6	130.3	102.4	150.8	115.4	170.4	144.3	211.3	186.2	254.2	230.0	297.9	274.6	56.8	32.6
	7	80.1	49.3	122.0	92.2	142.4	112.7	162.9	134.1	205.8	176.0	247.6	217.9	290.5	263.5	67.0	41.9
	8*	74.5	40.0	116.4	80.1	136.9	101.5	157.3	121.0	198.3	162.9	241.1	206.7	284.0	243.0	77.3	45.6
	9	66.1	25.1	108.0	67.0	129.4	88.4	149.0	108.0	191.8	150.8	232.8	193.6	274.6	233.7	86.6	54.9
	10	58.7	15.8	99.6	57.7	122.0	79.1	141.5	98.7	183.4	140.6	225.3	183.4	267.2	224.4	101.5	61.4
	11	52.1	-	93.1	46.6	113.6	66.1	135.9	85.7	176.9	127.5	218.8	169.4	260.7	249.5	111.7	68.0
	12	46.6	-	87.5	27.9	107.1	54.0	128.5	74.5	170.4	116.4	211.3	158.3	254.2	238.3	121.0	74.5
RS125	4	126.6	98.7	180.6	150.8	209.5	182.5	236.5	206.7	289.5	262.5	344.5	318.4	393.8	375.2	55.9	28.9
	5	116.4	78.2	168.5	133.1	196.4	161.1	224.4	189.0	275.6	242.1	328.6	298.9	378.0	359.4	74.5	38.2
	6	104.3	58.7	156.4	114.5	184.3	142.4	212.3	169.4	261.6	224.4	306.3	280.2	364.0	344.5	93.1	46.6
	7	96.8	38.2	149.0	94.0	179.7	122.9	202.0	149.0	257.0	203.9	310.0	261.6	371.5	329.6	108.0	55.9
	8*	84.7	31.7	138.7	76.3	165.7	103.3	193.6	130.3	246.7	185.3	299.8	239.3	361.2	317.5	125.7	68.0
	9	72.6	9.3	127.5	54.9	153.6	82.9	180.6	109.9	234.6	165.7	288.6	219.7	349.1	299.8	145.2	78.2
	10	60.5	-	115.4	37.2	140.6	65.2	168.5	90.3	221.6	148.0	275.6	204.8	327.7	260.7	163.9	91.2
	11	50.3	-	104.3	18.6	133.1	45.6	157.3	72.6	212.3	129.4	264.4	183.4	320.3	236.5	181.5	102.4
	12	41.0	-	95.0	-	122.0	27.9	147.1	55.9	202.0	109.9	254.2	162.9	309.1	219.7	196.4	109.9

※0° - 阀门关闭/90° - 阀门打开

内容

A series 拨叉式  
零件清单

A series 拨叉式  
选型指南  
尺寸表

A series 拨叉式  
扭矩表

R series 齿轮齿条  
零件清单

R series 齿轮齿条  
选型指南  
尺寸表

R series 齿轮齿条  
扭矩表

多种选择

限位开关

\*单元: Nm

模型	弹簧	供气 (气开式)															
		3Bar		4Bar		4.5Bar		5Bar		6Bar		7Bar		8Bar		弹簧复位	
		0°	90°	0°	90°	0°	90°	0°	90°	0°	90°	0°	90°	0°	90°	90°	0°
RS140	4	179.7	154.5	257.0	237.4	297.9	283.0	335.2	317.5	412.4	402.2	491.6	485.1	606.1	552.1	78.2	49.3
	5	175.0	132.2	252.3	211.3	290.5	252.3	329.6	291.4	405.9	372.4	486.0	454.3	599.6	524.2	95.9	55.9
	6	160.1	107.1	237.4	187.1	280.2	228.1	316.5	268.1	393.8	346.3	471.1	429.2	587.5	499.0	116.4	68.0
	7	146.2	84.7	223.4	165.7	262.5	206.7	300.7	246.7	381.7	325.9	459.0	407.8	575.4	477.6	139.7	82.9
	8*	131.3	65.2	211.3	146.2	249.5	186.2	288.6	225.3	366.8	305.4	443.2	385.4	560.5	461.8	160.1	95.0
	9	116.4	45.6	198.3	122.9	235.5	162.9	274.6	204.8	353.8	284.0	430.1	365.0	547.4	441.3	182.5	108.9
	10	95.9	18.6	178.8	96.8	219.7	138.7	261.6	180.6	338.0	261.6	416.2	342.6	533.5	419.0	205.8	126.6
	11	81.0	-	165.7	75.4	204.8	118.2	246.7	153.6	323.1	236.5	404.1	317.5	521.4	393.8	223.4	135.9
	12	75.4	-	153.6	54.0	191.8	94.0	230.9	131.3	312.8	212.3	393.8	293.3	509.3	373.3	245.8	145.2
RS160	4	261.6	221.6	372.4	336.1	429.2	390.1	482.3	445.0	594.0	559.5	710.4	670.3	820.2	780.2	114.5	71.7
	5	236.5	179.7	349.1	294.2	405.0	351.0	463.6	405.0	569.8	517.6	686.1	628.4	796.0	736.4	149.0	96.8
	6	214.1	150.8	326.8	264.4	383.6	317.5	438.5	375.2	550.2	485.1	661.0	596.8	770.9	703.8	179.7	115.4
	7	194.6	111.7	307.2	226.2	364.0	283.0	420.8	337.0	530.7	450.6	650.8	558.6	751.3	666.6	209.5	135.9
	8*	173.2	83.8	284.9	196.4	340.7	254.2	397.5	310.0	507.4	421.7	627.5	532.5	728.0	637.7	241.1	156.4
	9	152.7	51.2	263.5	159.2	317.5	219.7	374.3	274.6	484.1	393.8	604.2	499.0	704.8	605.2	270.9	177.8
	10	127.5	14.9	238.3	131.3	296.1	187.1	351.0	242.1	460.8	355.6	580.9	470.2	681.5	574.4	302.6	198.3
	11	117.3	-	220.6	98.7	280.2	156.4	332.4	212.3	447.8	326.8	567.9	442.2	668.5	546.5	331.4	216.9
	12	89.4	-	203.9	71.7	258.8	123.8	314.7	180.6	425.5	296.1	545.6	410.6	646.1	514.8	359.4	237.4
RS185	4	336.1	279.3	490.6	438.5	571.6	518.6	648.9	589.3	806.2	745.7	964.5	904.0	1,115.3	1,081.8	166.6	108.9
	5	320.3	240.2	471.1	391.0	554.9	469.2	628.4	547.4	789.5	703.8	941.2	864.9	1,091.1	1,030.6	214.1	143.4
	6	286.7	187.1	438.5	346.3	521.4	425.5	590.3	500.9	756.9	655.4	913.3	820.2	1,079.0	966.4	259.7	168.5
	7	253.2	136.9	409.6	290.5	486.0	374.3	559.5	449.7	734.6	612.6	883.5	767.1	1,031.5	933.8	309.1	203.9
	8*	216.9	90.3	380.8	245.8	458.1	323.1	534.4	403.1	702.0	560.5	855.6	718.7	990.6	887.2	356.6	234.6
	9	195.5	42.8	353.8	198.3	433.8	278.4	509.3	355.6	678.7	513.0	832.3	675.0	966.4	842.6	405.9	270.0
	10	161.1	-	320.3	147.1	405.9	226.2	476.7	306.3	633.1	467.4	790.4	624.7	924.5	788.6	457.1	294.2
	11	128.5	-	288.6	99.6	365.0	177.8	441.3	259.7	597.7	415.2	784.8	578.2	891.0	741.1	492.5	324.9
	12	105.2	-	258.8	48.4	340.7	137.8	416.2	216.0	572.6	376.1	738.3	527.9	865.8	691.7	543.7	357.5
RS210	4	518.6	438.5	744.8	670.3	868.6	784.8	956.1	897.5	1,219.6	1,170.3	1,443.1	1,364.8	1,660.0	1,576.2	233.7	152.7
	5	481.3	369.6	703.8	598.6	835.1	711.3	946.8	823.9	1,174.9	1,053.9	1,397.4	1,288.5	1,622.7	1,499.8	297.9	193.6
	6	438.5	308.2	663.8	532.5	776.5	644.3	901.2	756.9	1,139.5	988.7	1,360.2	1,220.5	1,576.2	1,442.1	356.6	233.7
	7	405.9	256.0	632.1	479.5	745.7	589.3	861.2	705.7	1,097.6	932.9	1,326.7	1,170.3	1,540.8	1,387.2	397.5	262.5
	8*	366.8	189.9	591.2	419.9	704.8	530.7	819.3	648.0	1,050.2	875.1	1,294.1	1,104.2	1,509.2	1,320.2	468.3	312.8
	9	319.3	118.2	542.8	345.4	655.4	462.7	768.1	568.8	1,010.1	801.6	1,240.1	1,026.9	1,453.3	1,254.1	533.5	355.6
	10	272.8	50.3	503.7	275.6	608.9	392.0	721.5	509.3	963.6	728.0	1,195.4	953.3	1,397.4	1,184.2	597.7	400.3
	11	236.5	-	456.2	214.1	574.4	331.4	686.1	448.7	911.4	676.8	1,162.8	905.9	1,364.8	1,123.7	649.8	442.2
	12	193.6	-	417.1	147.1	530.7	266.3	644.3	384.5	875.1	608.9	1,118.1	842.6	1,323.0	1,058.5	724.3	480.4

\*0° - 阀门关闭/90° - 阀门打开

\*Standard

# 多种选择

## ● 指示盖

A	B	D	E
			
· 螺丝固定指示盖	· 标准指示盖	· 塑料指示盖 R40/AR50~AR125	· 通过插入传感器可用指示盖。 R40/AR50~AR125

## ● 环氧树脂涂层执行器



- 硬质阳极氧化铝体后涂有环氧树脂。
- 用于化工管道。

## ● 侧面传感器



[ 传感器电路图 ]

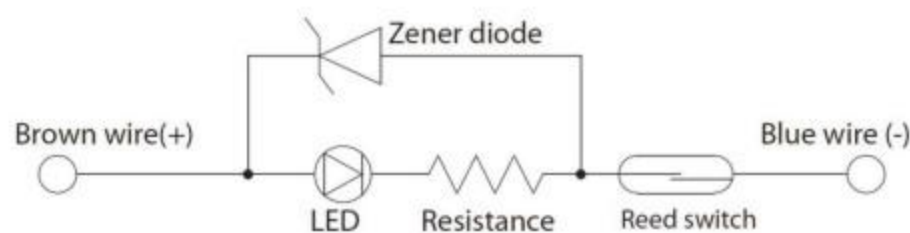

传感器规格

传感器	D-93K (KCC)	
应用	Relay, PLC	
电压	DC24V	AC110V
电流范围	5~40mA	5~20mA
触点保护电路	None	
内部电压降	≤2.7V	
指示灯	Red LED	
线长	1m(标准), 3m, 5m	

内容

A series 拨叉式  
零件清单

A series 拨叉式  
选型指南  
尺寸表

A series 拨叉式  
扭矩表

R series 齿轮齿条  
零件清单

R series 齿轮齿条  
选型指南  
尺寸表

R series 齿轮齿条  
扭矩表

多种选择

限位开关

## ● 停止

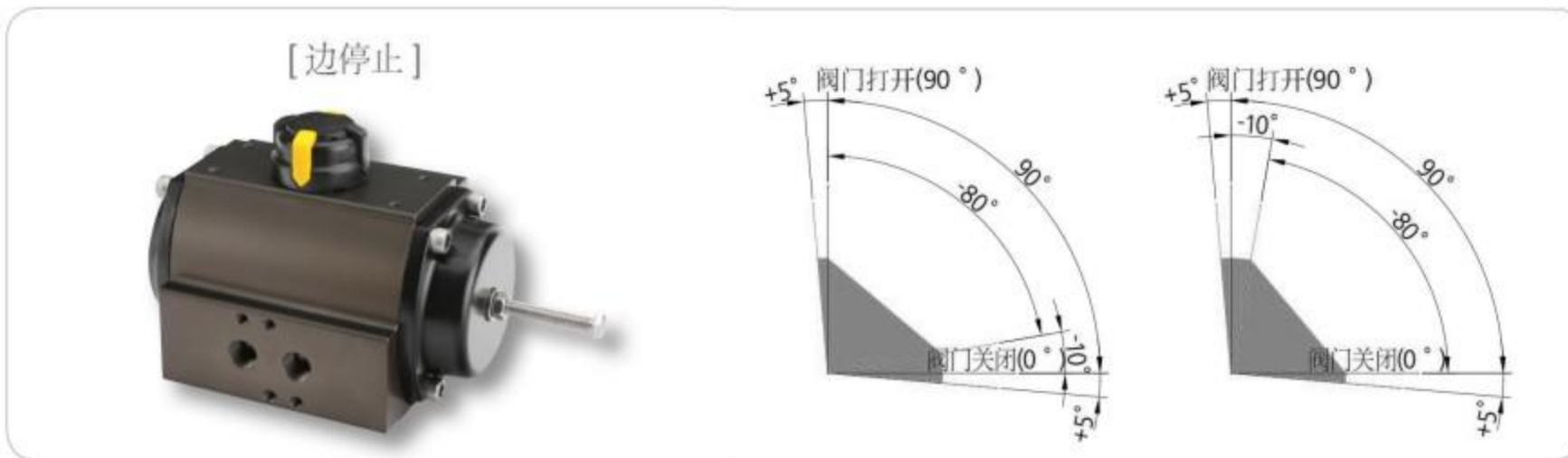
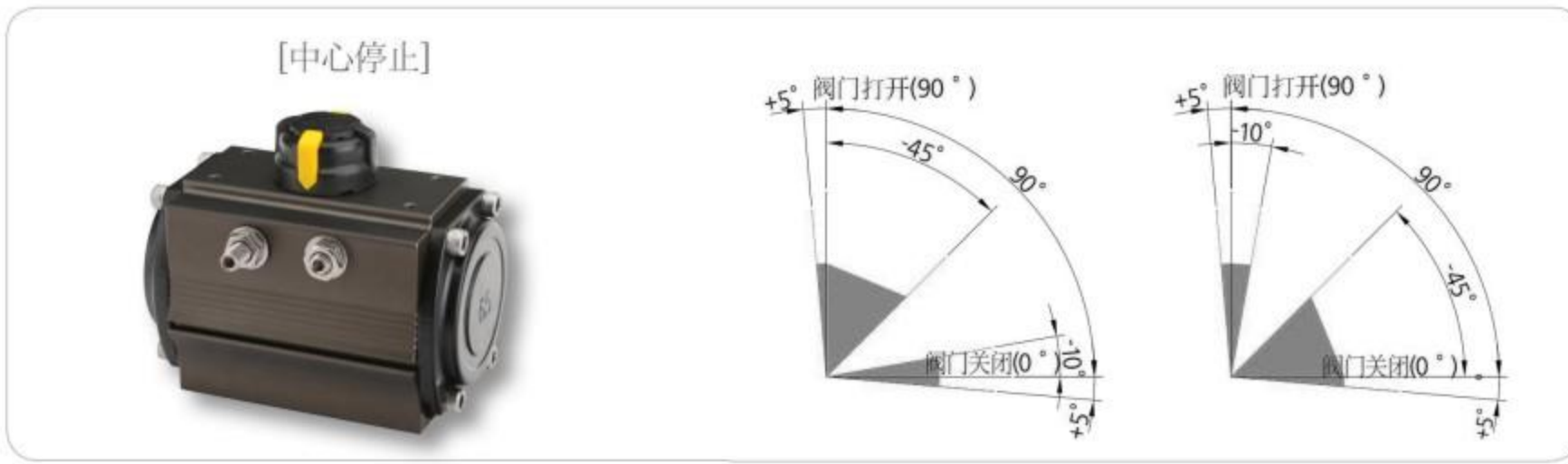

## 内容

A series 拔叉式  
零件清单

A series 拔叉式  
选型指南  
尺寸表

A series 拔叉式  
扭矩表

R series 齿轮齿条  
零件清单

R series 齿轮齿条  
选型指南  
尺寸表

R series 齿轮齿条  
扭矩表

多种选择

限位开关

## ● 端口焊盘



## ● 适配器

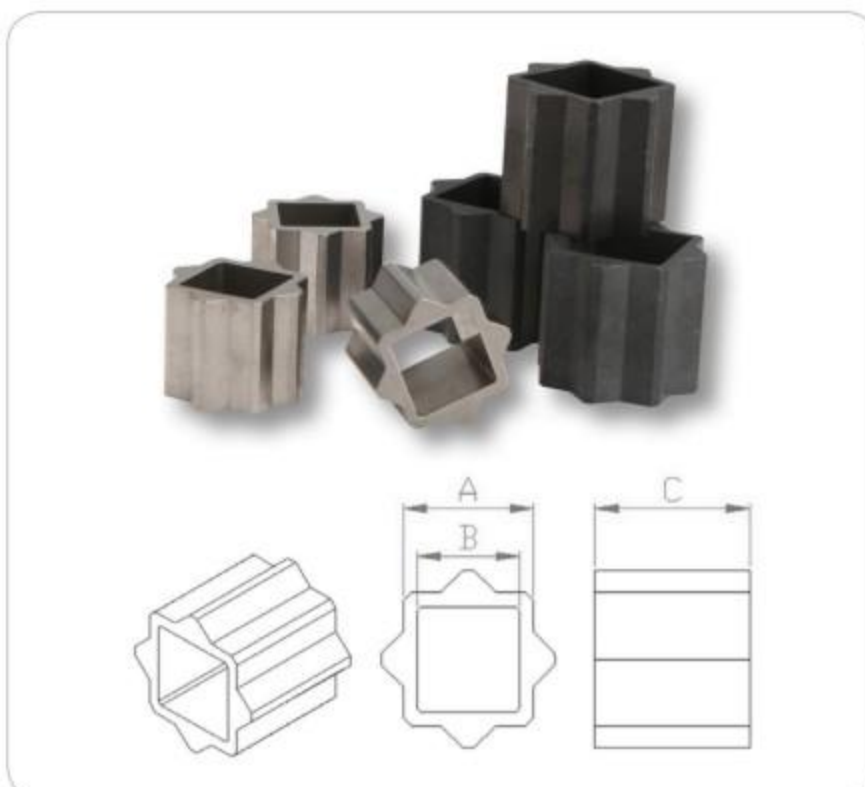

双方			单方		
A	B	C	A	B	C
11	9	12	11	9	10
14	9	15	14	9	15
14	11	15	14	11	16
17	14	18	17	11	17
17	11	18	17	14	17
22	14	24	22	17	22
22	17	24	27	22	27
27	17	27			
27	22	27			
36	27	38			

## ▶ A 型系列 (拨叉式) ISO5211 / 轴 / 重量

模型	ISO5211	轴	AD(Kg)	AS(Kg)
A50	F03/F05/F07	11*11	1.4	1.6
		#14*14		
		#9.7*15		
A65	F05/F07	14*14	2.3	3.0
		#11*11		
		#11.7* $\varnothing$ 17		
		#9.7* $\varnothing$ 15		
A80	F07	17*17	3.9	5.3
		#14.7* $\varnothing$ 19		
A100	F07/F10	22*22	6.7	9.5
		#17.7* $\varnothing$ 22		
A125	F07/F10	22*22	11.3	17.6
A140	F10/F12	27*27	16.4	23.9
		#22*22		
A160	F14	36*36	23.7	36.6
	#F10/F12	#27*27		
A185	F14	36*36	34.8	56.9
A210	F16	46*46	45.5	77.2
	#F14	#36*36		
A250	F16	46*46	65.8	119.6
A300	F16/F25	55*55	165	275.5

#Option

## ▶ R 型系列 (齿轮齿条) ISO5211 / 轴 / 重量

模型	ISO5211	轴	RD(Kg)	RS(Kg)
RD32	F03	9*9	0.3	-
R40	F03/F05	9*9	0.5	0.6
	#F04			
R50	F03/F05/F07	11*11	1.0	1.1
	#F04			
R65	F05/F07	14*14	1.4	1.5
	#F04/F07			
R80	F05/F07	17*17	2.9	3.3
R90	F07	17*17	3.4	3.8
R100	F07/F10	22*22	4.7	5.4
		#17*17		
R115	F07/F10	22*22	6.7	7.5
R125	F07/F10	22*22	8.6	9.9
R140	F10/F12	27*27	12.4	14.5
		#22*22		
R160	F10/F12	27*27	16.9	19.5
R185	F10/F12	36*36	24.2	29.0
R210	F14	36*36	32.3	37.9

#Option